



Search



Grumpy Goat ▾



Inbox



Alerts



Home

Forums

Members

Gallery

Home > Forums > BMW R1200RS Forums >

Post New Thread

Removing fairings

Discussion in 'General R1200RS Discussions' started by Grumpy Goat, Oct 7, 2015.

Page 2 of 3 < Prev 1 2 3

Thread Tools

Unwatch Thread

Next >



Anyway GG, I hope you're working on this pictorial guide. I'm counting on you

Peter Burridge

Well-Known Member

Contributor

Messages: 2,783

Likes Received: 1,52

1

Trophy Points: 113

Never hesitate to ride past the last street light at the edge of town.

Peter Burridge, Oct 9, 2015 Report #21 Like Reply



Grumpy Goat

Well-Known Member

Contributor

Messages: 4,004

Likes Received: 2,545

Trophy Points: 113



I am shooting for doing that this weekend. Should be hot so that will cut into my riding a bit.

--

Regards

Grumpy Goat

Houston, TX

2016 BMW R1200RS Granite Grey Premium ("Grump the Grey")

Grumpy Goat, Oct 9, 2015 [Edit](#) [Delete](#) [Report](#)
#22 [Reply](#)



Grumpy Goat

Well-Known Member

Contributor

Messages: 4,004

Likes Received: 2,545

Trophy Points: 113



As promised, the attached PDF documents what I did to remove the side fairings. I had some computer problems yesterday or else it would have been posted then.

Hope the steps and text are clear enough. Essentially, removing the fairings on this bike is easy; way easier than on my Honda. Once you know where the hidden attachment points (e.g. tabs) are and the removal order, then the rest is easy. No force is necessary.

As I said in the document, be very careful of misplacing the clear plastic washers on the screws with the bosses under the screw

heads - they are pretty hard to find if
dropped.



Attached Files:

Remo...

File size:

760.1 KE

Views:

248

—

Regards

Grumpy Goat

Houston, TX

2016 BMW R1200RS Granite Grey Premium ("Grump the
Grey")

Grumpy Goat, Oct 12, 2015 [Edit](#) [Delete](#) [Report](#)
[#23](#) [Reply](#)

DABs, apehair, Joerg58 and 6 others like this.



Peter Burridge

Well-Known Member

Contributor

Messages: 2,783

Likes Received: 1,52

1



Grumpy Goat said: ↑

As promised, the attached PDF documents what I did to remove the side fairings. I had some computer problems yesterday or else it would have been posted then.

Click to expand...

Trophy Points: 113

Thats a very useful resource GG and many thanks for your efforts

Peter

Never hesitate to ride past the last street light at the edge of town.

Peter Burrige, Oct 12, 2015 Report

#24 Like Reply



Grumpy Goat

Well-Known Member

Contributor

Messages: 4,004

Likes Received: 2,545

Trophy Points: 113



Peter Burrige said: ↑

Thats a very useful resource GG and many thanks for your efforts

Peter

My pleasure, Peter.

--

Regards

Grumpy Goat

Houston, TX

2016 BMW R1200RS Granite Grey Premium ("Grump the Grey")

Grumpy Goat, Oct 12, 2015 Edit Delete Report

#25 Reply



Grumpy Goat said: ↑

Ed Greenberg

Member

Messages: 45

Likes Received: 33

Trophy Points: 18

As promised, the attached PDF documents what I did to remove the side fairings. I had some computer problems yesterday or else it would have been posted then.

Hope the steps and text are clear enough.
Click to expand...

Thanks for posting these instructions. I'm sure that they'll be helpful for many of us on this forum!

Ed Greenberg, Oct 12, 2015 Report

#26 Like Reply



Lars Ormvold

Active Member

Messages: 246

Likes Received: 136

Trophy Points: 43



Grumpy, if you go to [http://realoem.com/bmw/enUS/partgrp?id=0A05-EUR---K54-BMW-R 1200 RS \(0A05, 0A15\)&mg=46](http://realoem.com/bmw/enUS/partgrp?id=0A05-EUR---K54-BMW-R%201200%20RS%20(0A05,0A15)&mg=46) you will find exploded views to help locate screws etc when you are to install again.

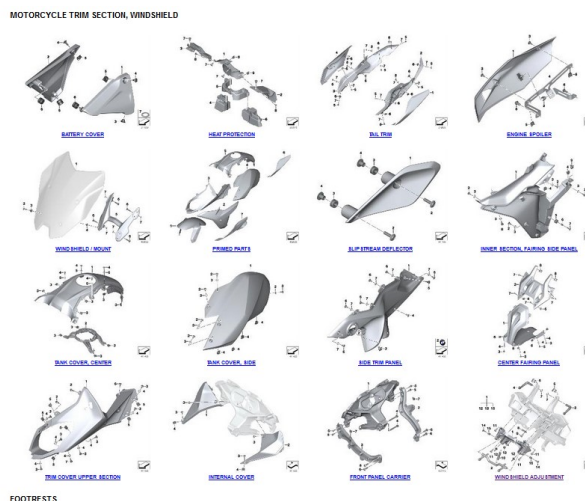

lars Ormvold, Oct 12, 2015 Report

#27 Unlike Reply

You, apehair, Joerg58 and 2 others like this.



KOCook

Active Member

Messages: 230

Likes Received: 168

Trophy Points: 43



Good work GG. That PDF will no doubt be very useful to everyone. I am so used to pulling this stuff off & putting back on, don't really think much about it anymore. BMW is a piece of cake & the parts fiche, although not always exactly like one's own machine, is useful. Try a Honda RR if you want to consider suicide out of frustration.

Kent

BMW Riders Association Trustee, OTL Contributor

Lone Star Track Days Instructor

KOCook, Oct 12, 2015 Report

#28 Unlike Reply

You and Aussie Import like this.



Grumpy Goat

Well-Known Member

Contributor



lars Ormvold said: ↑

Grumpy, if you go to [http://realoem.com/bmw/enUS/partgrp?id=0A05-EUR--K54-BMW-R 1200 RS \(0A05, 0A15\)&mg=46](http://realoem.com/bmw/enUS/partgrp?id=0A05-EUR--K54-BMW-R 1200 RS (0A05, 0A15)&mg=46) you will find exploded views to help locate screws etc when you are to install again.

Messages: 4,004

Likes Received: 2,545

Trophy Points: 113

Thanks - Excellent parts list and exploded view! Saved to favourites!

—
Regards

Grumpy Goat

Houston, TX

2016 BMW R1200RS Granite Grey Premium ("Grump the Grey")

Grumpy Goat, Oct 12, 2015 [Edit](#) [Delete](#) [Report](#)
#29 [Reply](#)



Grumpy Goat

Well-Known Member

Contributor

Messages: 4,004

Likes Received: 2,545

Trophy Points: 113



KOCook said: ↑

Good work GG. That PDF will no doubt be very useful to everyone. I am so used to pulling this stuff off & putting back on, don't really think much about it anymore. BMW is a piece of cake & the parts fiche,

I know what you mean about not thinking about the steps once you get it done one or more times. The thing is getting the sequence right, and is what something like a shop manual would provide as opposed to a parts list.

My next set of mods will involve the battery and I will start another separate thread for that.

--

Regards

Grumpy Goat

Houston, TX

2016 BMW R1200RS Granite Grey Premium ("Grump the Grey")

Grumpy Goat, Oct 12, 2015 [Edit](#) [Delete](#) [Report](#)
#30 [Reply](#)

Peter Burridge likes this.



Grumpy Goat

Well-Known Member

Contributor

Messages: 4,004

Likes Received: 2,545

Trophy Points: 113



Please see here for my help request regarding connecting to the battery.

--

Regards

Grumpy Goat

Houston, TX

2016 BMW R1200RS Granite Grey Premium ("Grump the Grey")

Grumpy Goat, Oct 12, 2015 [Edit](#) [Delete](#) [Report](#)
#31 [Reply](#)



Aussie Import



Grumpy Goat said: ↑

Please see here for my help request regarding connecting to the battery.

Well-Known Member

Messages: 2,893

Likes Received: 1,973

Trophy Points: 113

I don't know for sure, Grumpy. I am getting my RS later today (if the dealer is a truthful man). However, pages 147 and 148 of the owners manual suggest you have to disconnect the negative terminal, remove the battery restraint, drag the battery out towards you, and then disconnect the positive terminal. Fiddly perhaps, but a hell of an improvement over the R1100S. If you think that is bad, my son has a Husky Nuda 900R (heavily modified, photo attached). As you know this is based on the F800. The battery is supposed to be pulled out towards the right, and then dropped down for removal. His view is that there is insufficient clearance, and to replace the battery will require main frame removal!!



Attached Files:

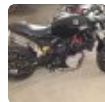

Husky...

File size:

1.7 MB

Views:

28

Aussie Import, Oct 12, 2015 Report

#32 Like Reply

Aussie Import said: ↑



Grumpy Goat

Well-Known Member

Contributor

Messages: 4,004

Likes Received: 2,545

Trophy Points: 113



I don't know for sure, Grumpy. I am getting my RS later today (if the dealer is a truthful man). However, pages 147 and 148 of the owners manual suggest you have to disconnect the negative terminal, remove the battery restraint, drag the battery out towards you,

Well blow me down with a feather, and now I feel like a fool. I will confess that I have not read that far in the manual (on pg.116)! Thanks for pointing that out.

Good luck with the pickup of the RS!

—

Regards

Grumpy Goat

Houston, TX

2016 BMW R1200RS Granite Grey Premium ("Grump the Grey")

Grumpy Goat, Oct 12, 2015 [Edit](#) [Delete](#) [Report](#)
#33 [Reply](#)



jlduck

Well-Known Member

Messages: 615



Thanks for the pdf, Grumpster! And thanks for the link, Lars! I'll put those in my files for future reference. Right now, I'm still happy just sitting in my garage admiring the bike, not feeling the need to take shit apart. Yet.

Likes Received: 571

Trophy Points: 93



runnerhiker

Well-Known Member

Contributor

Messages: 711

Likes Received: 449

Trophy Points: 63

jlduck, Oct 12, 2015 Report

#34 Like Reply



Aussie Import said: ↑

I don't know for sure, Grumpy. I am getting my RS later today (if the dealer is a truthful man). However, pages 147 and 148 of the owners manual suggest you have to disconnect the negative terminal, remove the battery
Click to expand...

I installed a Powerlet outlet directly to the battery. Access to the battery posts is exactly as Aussie describes here. Very easy.

'16 R1200 RS

'17 Bonneville T120

'17 Super Duke R

Niwot, CO

runnerhiker, Oct 12, 2015 Report #35 Like Reply



Grumpy Goat

Well-Known Member

Contributor

Yes, after I read the manual and these posts I have come to the same conclusion. Connecting to the battery is just as simple and straightforward as on my Honda.

I was just apprehensive since the

Messages: 4,004

Likes Received: 2,545

Trophy Points: 113

conventional wisdom is that German vehicles that are full of electronics have precisely that as their achilles heel. Consumer Reports supports this too. I just did not want to run the risk of messing something up on my brand new bike and then have BMW say "not covered".

I will get the Denali hub and disturb the battery only once.

--

Regards

Grumpy Goat

Houston, TX

2016 BMW R1200RS Granite Grey Premium ("Grump the Grey")

Grumpy Goat, Oct 13, 2015 [Edit](#) [Delete](#) [Report](#)
#36 [Reply](#)



Joerg58

New Member

Messages: 18

Likes Received: 7

Trophy Points: 3

◀ Hello Wayne,
congratulations for your documation with the fairings.

When you want to connect something directly with the battery, because in front of the CAN-Bus system it's not necessary to get out the battery. Only disconnect the negativepole on the left. A little bit right of the battery is a connectionpoint for the pluspole, covered with a red plasticcap. If

you want to use the CAN-Bus, there is a special adapter available at the dealer.

Here is a link to video how to connect another horn to a R1200R, the work at the battery is the same.



I have done the work on my RS, It's a little bit different.

Joerg

P.S. Oh, sorry I'm a little bit to late, have just seen there is another thread

Last edited: Oct 13, 2015

Joerg58, Oct 13, 2015 Report #37 Like Reply



Joerg

Grumpy Goat

Well-Known Member

Contributor

Messages: 4,004

Likes Received: 2,545

Trophy Points: 113

Thanks for the appreciation of my write-up and also he link to the horn installation showing the installer using the secondary +ve terminal.

The manual is a little confusing on the use of this terminal - on the one hand it suggests that you can jump start the bike using this terminal, and then not to far away on the same page it suggests using the battery poles only. This casts doubt on the electrical robustness of the secondary terminal.

That said, I will likely be using this secondary terminal until I get my fuse block and then I will re-do the hookup directly to the battery poles. I don't anticipate getting the fuse block before returning to work on Monday. I typically ride with my phone plugged in and charging, so I have to install a handlebar-mounted 12V SAE cig lighter socket / USB outlet accessory I have on the other bike.

--

Regards

Grumpy Goat

Houston, TX

2016 BMW R1200RS Granite Grey Premium ("Grump the Grey")

Grumpy Goat, Oct 13, 2015 [Edit](#) [Delete](#) [Report](#)
#38 [Reply](#)



Aussie Import

Well-Known Member

Messages: 2,893

Likes Received: 1,973

Trophy Points: 113



Grumpy Goat said: ↑

Joerg

The manual is a little confusing on the use of this terminal - on the one hand it suggests that you can jump start the bike using this terminal, and then not

Thank you Grumpy for your excellent work on the removal of the fairings.

I know that my modification is to install the horns with a relay (fused) and that at full pelt, the horns draw 9 amp. I have no problem with the accessory terminal as the cable leading to it looks to be about 5 or 6 mm and the recommended feed for the horns is 2.5 mm.

When I can actually pry my bottom from my office chair, or from the saddle, I will attend to the work. I have prepared the terminals and wiring already.

The RS is really something. Easy on the eye. Easy on the body. Easy on the road. Huge power / torque at low-ish rpms. Hard on the wallet, but what the hell.

Aussie Import, Oct 13, 2015 Report

#39 Unlike Reply

You like this.



runnerhiker

Well-Known Member

Contributor

Messages: 711

Likes Received: 449

Trophy Points: 63

Besides the new RS, I also have a 2014 GSW. I connected the Powerlet socket directly to the GS battery terminal. Here is the part I don't remember well: I think I installed the Powerlet to the red, easily accessible terminal and the battery tender didn't work, as though this terminal is on the CanBus side of the electrical system and turned off when the ignition is off.

Too bad I don't distinctly remember. But if you have problem with a battery tender, this might help.

'16 R1200 RS

'17 Bonneville T120

'17 Super Duke R

Niwot, CO



runnerhiker, Oct 14, 2015 Report

#40 Unlike Reply

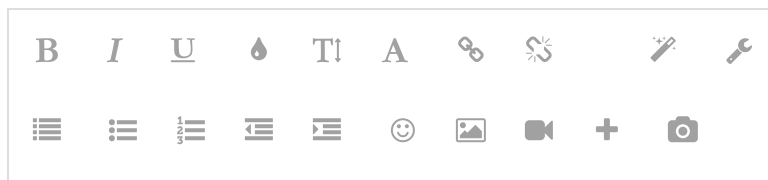
You and Peter Burr ridge like this.





Write your reply...

Similar Threads

	Removing ECU Pietah55, Apr 3, 2018, in forum: Servicing & Maintenance	Replies: 9 Views: 278	ady Apr 5, 2018
	Removing the Shift Assist Pro SauRoN, Mar 29, 2018, in forum: Servicing & Maintenance	Replies: 4 Views: 335	Tony101 Mar 29, 2018
	Question re: Removing BMW Engine Protection Bars goodman312, Nov 5, 2017, in forum: R1200RS Appearance Mods	Replies: 26 Views: 816	goodman312 Nov 19, 2017
	Removing Tar SauRoN, Apr 10, 2017, in forum: Servicing & Maintenance	Replies: 13 Views: 749	DonT45RS Jan 29, 2018
	Removing Battery Help Slipperman, Mar 5, 2017, in forum: Servicing & Maintenance	Replies: 16 Views: 1,013	wessie Nov 15, 2017

Tags: [Fairing](#), [Remove](#) (Edit Tags)

Share This Page

[Tweet](#)
[G+](#)

 One person recommends this. Be the first of your friends.

XenForo add-ons by Waindigo™ ©2014 Waindigo Enterprises Ltd.

[Home](#) > [Forums](#) > [BMW R1200RS Forums](#) >

Style Chooser

[Terms and Rules](#) [Contact Us](#) [Help](#) [Home](#) 

Advertising Positioning by Digital Point
Forum software by XenForo™ ©2010-2015 XenForo Ltd.